

Wall-Mounted Wireless Keypad

User Manual

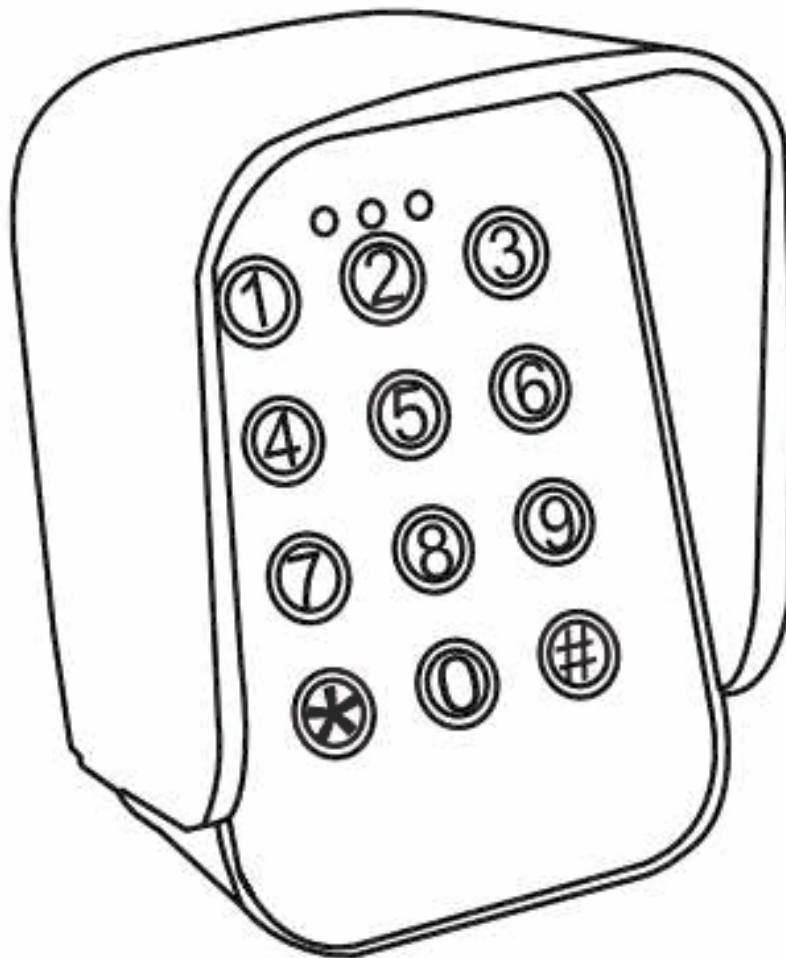

Please read this manual carefully before install and use.

Please keep the user manual for future reference.

Contents

Specifications	1
Package list	1
Mounting Tool	1
Introduction	2
Keypad Description	2
Feature	2
Safety Information	3
Assembly & Mounting	3-5
Keypad pass code.....	6-7
Assign the keypad to a tubular motor or a receiver.....	7
Keypad two channels.....	8
Change two channels' pass code	8
Operate the keypad to control the receiver	8
Reset the entry pass code	9
Mute or tun the buzzer	9
Turn on or turn off the back light.....	9-10
pass code Testing	10
Battery Life Checking	10
Keypad Deactivation	10
Reset the keypad	10
Maintenance	11
Trouble Shooting	11-12

Specifications

Material	ABS	
Model	Alpha Keypad	
Frequency	433.92mhz	
Code	Customized rolling code	
Channel	1 Channel	
Max. Signal Range	109.4 yd.	100m
pass code Capacity	11	
Working Temp.	14-140°F	-10 to 60°C
Battery	4×AA Alkaline	
IP Class	IP 55	
Dimensions	3.6×4.8×3.3 in.	90×120×82 mm
Weight	0.95 lbs	0.43 kg

Package list

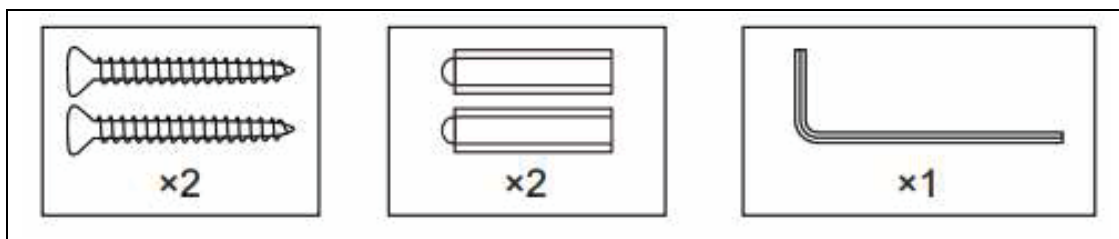

Mounting Tool

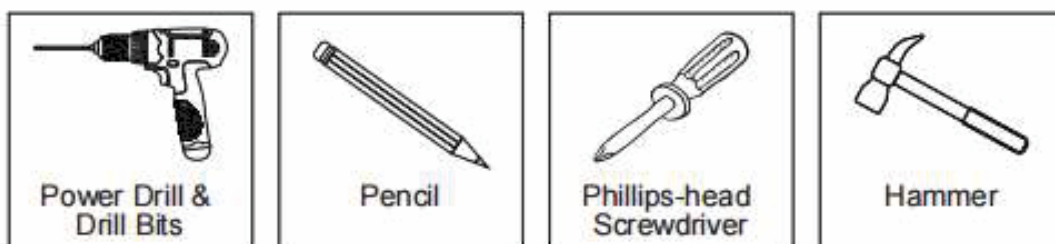

Introduction

The keypad has been integrated with an LED backlight key feature. It will bring you great pleasure and convenience while you use it to operate the Gate Opener. Be sure to read the manual carefully and completely before you permanently mount the keypad, please program the keypad and test its function prior to installation.

Keypad Description

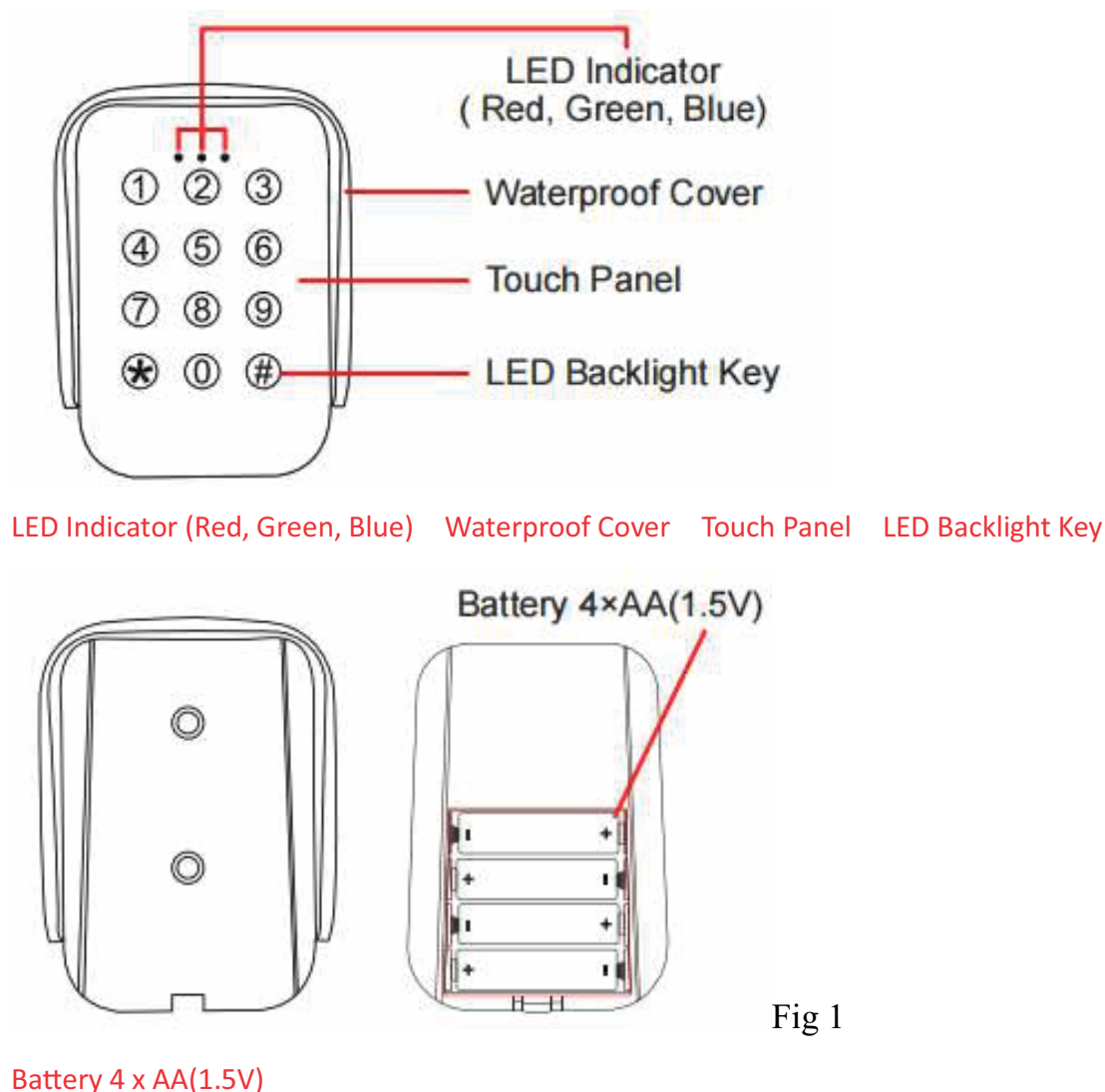

Fig 1

Feature

- Touch panel wireless keypad.
- Press any button to activate the keypad.
- Low battery prompt function: If the battery power is low (less than 80%), the device will make a sound prompt after each encoding is sent.
- The safety anti-tamper function uses a travel switch. When the host shell

is illegally opened, the system will always sound an alarm.

- Prevent your pass code from being spied on.
- Mute and unmute the buzzer.
- Turn on/off the backlight.
- Keypad deactivation while there is wrong pass code attempted.

Safety Information

- ONLY permit children to use this device under close and constant supervision.
- DO NOT pair this device with more than one gate opener circuit board.
- Cease use IMMEDIATELY if any irregularity occurs. Recalibrate, repair, or replace problematic parts before further use.

Assembly & Mounting

1. Your wireless keypad should arrive with the cover installed. Use the provided hex wrench to remove the cover locking bolt. Place the bolt nearby.

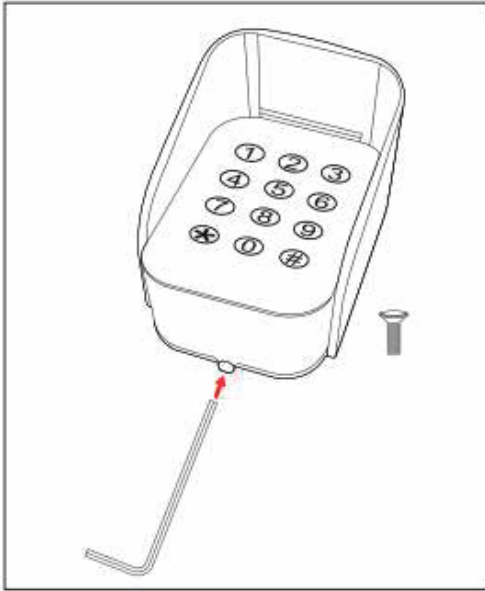

Fig 2

2. Slide the keypad out of its cover to expose the mounting holes. Press the cover against the wall on which you desire to install your keypad. Make two dots on the wall through the holes using a pencil or an equivalent (not included).

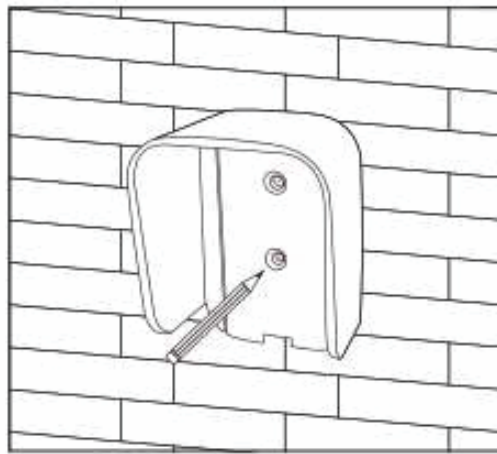
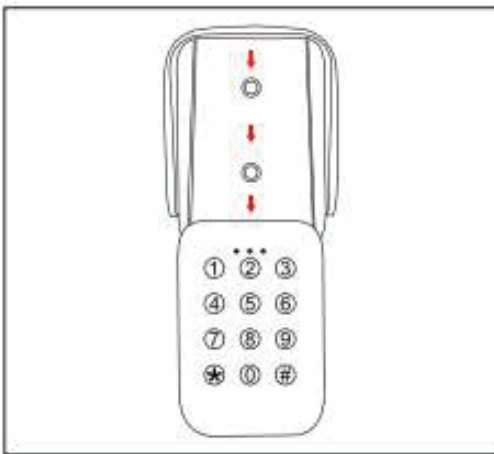

Fig 3

3. Match the anchors against your drill bits, being sure the one touse is only a bit bigger and wider than the anchors.

4. Drill two holes where the dots were marked using the selected drill bit, being sure you go at least 3.9 cm into the wall.

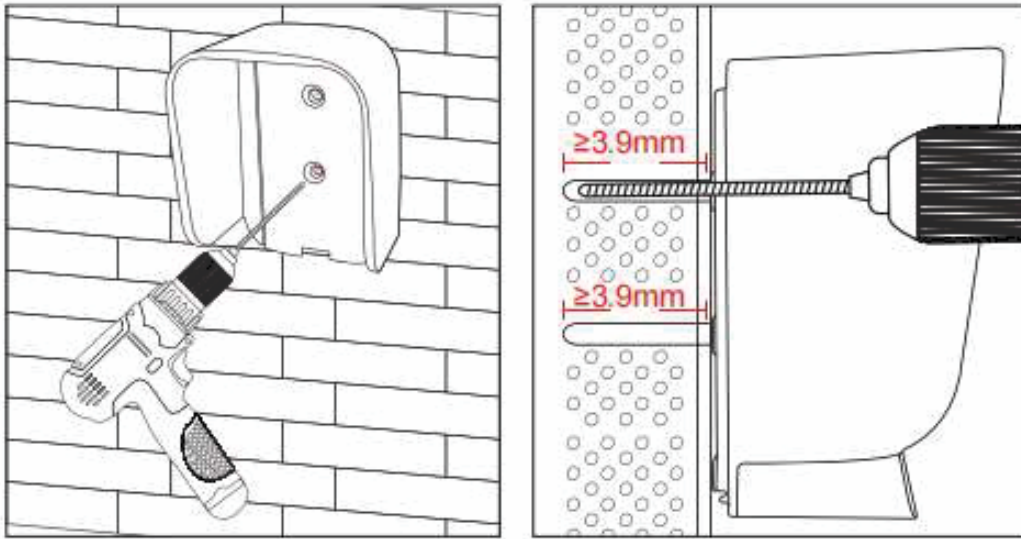

Fig 4

5. Use a hammer to tap the expansion screw tube into the hole. Mount the cover using the provided mounting screws ensuring that its closed end faces up.

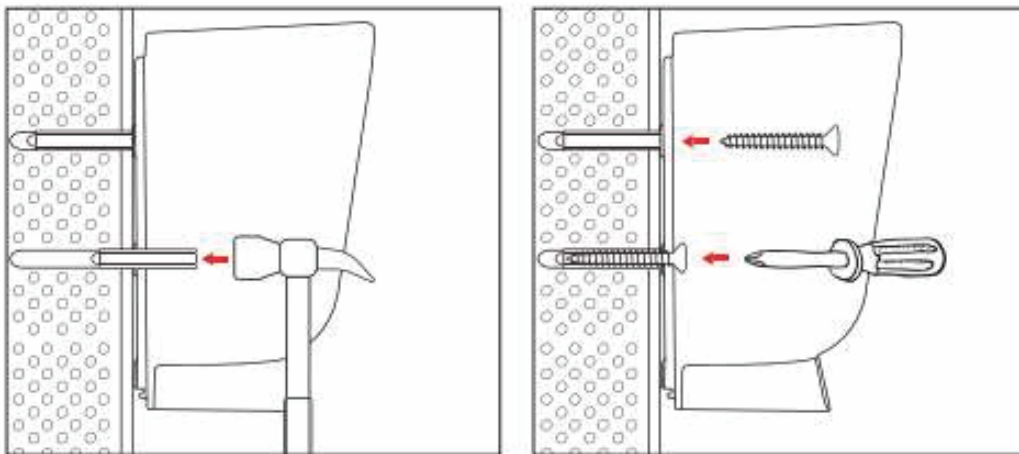

Fig 5

6. Remove the insulation installed inside the battery. You should hear a short beep followed by a long beep. Mute the beep by holding the travel switch on the top of the keypad. If the beep didn't sound, contact customer service.

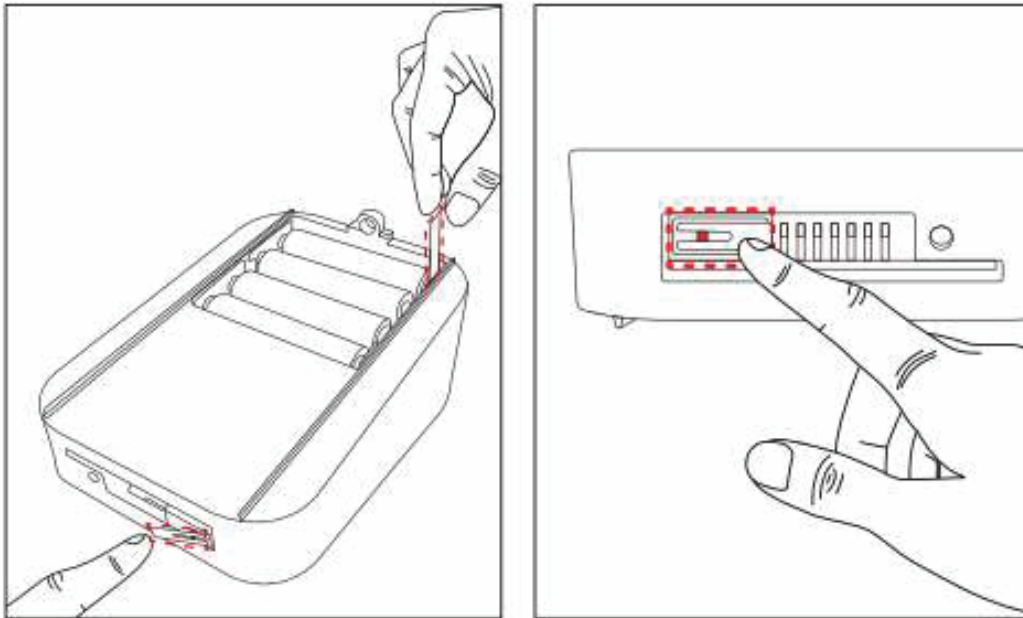

Fig 6

7. Slide the keypad back in, being sure the end with an interlock.

8. Presses against the interior of the cover. Replace the cover locking bolt and secure the keypad.

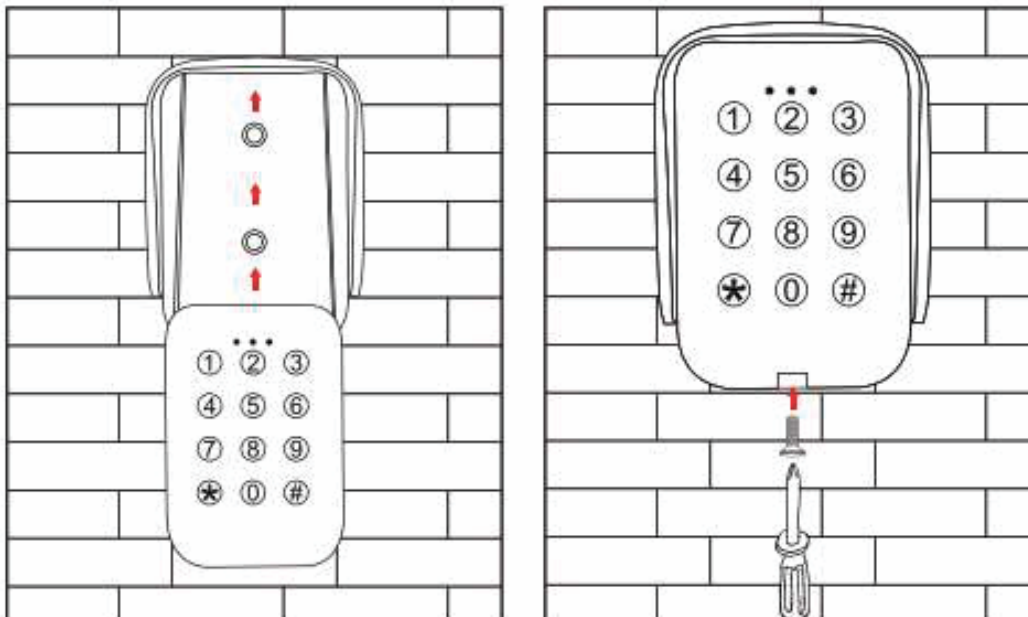

Fig 7

Keypad pass code:

The keypad is set with 4-digit pass code. Default is 0000*. You have to enter the correct pass code before you do any programming.

The pass code can be changed by following steps:

1. Enter **0000***, the keypad will sound a long beep and its blue backlight lights up.
2. Enter **69** and **#**, the keypad will sound a short beep.
3. Enter a new programming protection pass code, for example **0000** and **#**.

The keypad will sound a long beep followed by a short beep to confirm that the new pass code is set successfully.

Assign the keypad to a tubular motor or receiver

1. Enter pass code 0000*. The keypad will sound a long beep and its blue backlight lights up.
2. Enter 55#. The keypad will sound a long beep, and transmit an RF signal for 10 seconds.
3. Short Press tubular motor's program button and release (most WSER motors program button is at the motor head, for other motors, please refer it's user manual). Wait for a while, the keypad will sound a long beep followed by a short beep, means the keypad is assigned to the tubular motor.

If you are assigning this keypad to a receiver, follow above step 1& 2, power on your receiver, and press the "Learn" button. If the receiver's indicator LED flash and sound a "click", it means the keypad has already been programmed to the receiver.

Keypad two channels

The keypad has two channels, each channel controls the tubular motor to run in one direction.

Channel 1 pass code is 1111.

Channel 2 pass code is 2222

Enter 1111#, the tubular motor will run in one direction.

Enter 2222#, the tubular motor will run in another direction.

Make sure to set tubular motor's upper and lower limit before hand. There is no way to stop the motor by keypad unless it arrives to limits, or by remote.

Change two channels' pass code

Step 1. Enter keypad's pass code **0000***.

Step 2. Enter 01 and #. The keypad will sound a beep.

Step 3. Enter a new pass code 5555#. The keypad will sound a long beep followed by a short beep, confirm that the new entry pass code has been saved for channel 1.

Note!

1. Factory default: 01 is channel 1, 02 is channel 2. Set the entry pass code for channel 2, please repeat above steps, but only change 01 to 02.
2. If you hear no beep and see the red light blink 5 times, that means the pass code you entered already exists and the keypad will automatically exit the pass code setting mode.
3. In any channel, if the pass code quota is out, the red light will blink 5 times and exit. However, if the user still operates to add a new entry pass code, the keypad will delete the first pass code from the channel, and save the new pass code as the last pass code.

Note! This keypad includes an anti-spying mode. To prevent your pass code from

being spied on, follow the steps below.

1. Press any numerical buttons (0-9) on the keypad and include your pass code in the right order.
2. Press #. The keypad will automatically sort out your pass code and control the receiver.
3. Such as, enter 1234567895555#, and the receiver will be activated.

Reset the entry pass code

If you forgot your entry pass code, follow the steps below to reset the entry pass code for the 01 and 02 channels.

Step 1. Enter programming protection pass code 0000*. The keypad will sound a long beep and its blue backlight lights up.

Step 2. Enter 00#. The keypad will sound a long beep followed by a short beep, confirming that all the entry pass codes have been deleted.

Now the keypad is back to factory default pass code: 1111 for channel 1, and 2222 for channel 2.

Mute or turn on the buzzer

Step 1. Enter programming protection pass code 0000*. The keypad will sound a long beep and its blue backlight lights up.

Step 2. Enter 36#. The keypad will sound a long beep followed by a short beep, the mute operation has been saved.

Note!

1. If you want to turn on the buzzer, please repeat the above operation.
2. Mind that the mute only applies to normal operations. When in programming mode, the keypad still beeps to indicate/confirm your operations. After being reset, the keypad beeping will resume.

Turn on or turn off the backlight

Step 1. Enter programming protection pass code 0000*. The keypad will sound a long beep and its blue backlight lights up.

Step 2. Enter 39#. The keypad will sound a long beep followed by a short beep, and the turn off the backlight operation has been saved.

Note! If you want to turn on the backlight, please repeat the above operation.

pass code Testing

Follow the below steps to find out which channel a pass code is using.

Step 1. Enter programming protection pass code 0000*. The keypad will sound a long beep and its blue backlight lights up.

Step 2. Enter 86#. The keypad will sound like a short beep.

Step 3. Enter the 4-digit entry pass code and #. If the keypad sound one beep, means 01 channel. Two beeps mean 02 channel.

Battery Life Checking

Step 1. Enter programming protection pass code 0000*. The keypad will sound a long beep and its blue backlight lights up.

Step 2. Enter 89#. A long beep means the batteries have a serviceable life, while a short beep accompanied by a lit red light means the batteries need changing.

Keypad Deactivation

Your keypad will sound an alarm 3 times, light the red light, and remain deactivated for 2 minutes after 3 consecutive wrong pass code attempts.

As this happens, all buttons stay deactivated. Wait till a short beep is sounded and the red light dims to normally use the keypad.

Reset the keypad

Step 1. Remove the cover locking bolt and slide out the keypad.

Step 2. Gently hold the reset button located near the interlock pin using a pin or a similar tool until all the lights on the keypad light up, indicating the reset is done.

Step 3. After you reset the keypad, the factory defaults the programming protection is 0000. The channel 1 entry pass code is 1111 and the channel 2 entry pass code is 2222. Please modify these pass codes by referencing the manual, if needed.

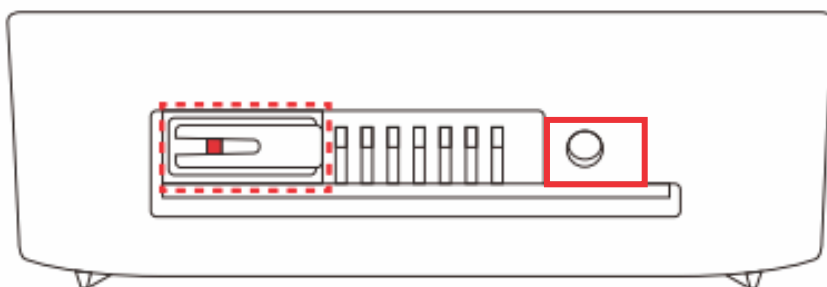

Maintenance

- Remove the batteries and store them in a cool dry place away from direct sunlight and inaccessible to children.
- Clean the keypad with a dry soft cloth. Don't rinse.

Trouble Shooting

Problem	Repair Method
Fail to program the keypad to the receiver	a. Check if the battery is exhausted. b. Program the keypad with the receiver again.
Fail to operate the keypad to control the receiver	a. Check if the battery is exhausted. b. The distance is too far to use the keypad(Please install the keypad

	near the receiver).
Forget your entry pass code	Please read the manual to reset the entry pass code.
Forget your programming protection pass code	Please read the manual to reset the keypad and modify your pass code again.